

ARTICLE 16
SERRE-CABLE ETRIER ZINGUE RAINURE
"CE"

ACIER ESTAMPE A FROID

D	PDS/G	A / CLE	H	I	L	R	S	NM	N	BOITAGE
3	9	M4/ 7	18	9	20	7	10	1.25	3	100
5	20	M5/ 8	24	13	24	10	15	2.46	3	300
6	33	M6/10	27	15	28	11	16	4.24	3	200
8	40	M6/10	31	17	34	12	18	4.24	5	150
10	79	M8/13	37	20	42	13	21	10.20	5	70
13	130	M10/17	44	25	55	15	26	20.11	5	40

ACIER ESTAMPE A CHAUD

14	145	M10/17	47	27	57	18	27	20.11	5	35
16	175	M10/17	51	29	63	20	28	20.11	5	30
18	260	M12/19	56	34	75	21	32	34.43	5	30
20	290	M12/19	62	34	75	22	33	34.43	5	30
22	340	M12/19	65	39	85	25	35	34.43	7	25
26	490	M14/22	72	42	95	27	40	54.77	7	
30	620	M14/22	78	47	110	33	43	54.77	8	
34	840	M16/24	88	53	120	37	48	85.14	8	
40	1120	M16/24	98	59	140	40	54	85.14	8	

N = NOMBRE DE SERRE CABLES PAR BOUCLE
NM = COUPLE DE SERRAGE

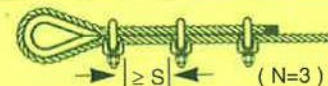

SERRE CABLE ETRIER DIN 741 GAMME ECONOMIQUE PAGE 35

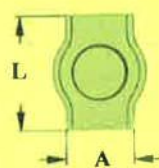
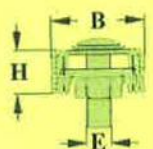
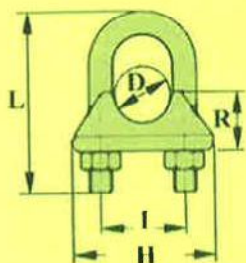

ARTICLE P1B

SERRE-CABLE PLAT 1 BOULON SERTI

D	PDS/G	A	B	E	H	L	BOITAGE
2	5	8	12	M4	5	18	100
3	8	9	14	M4	6	20	100
4	12	12	17	M5	7	22	100
5	20	14	20	M5	8.5	24	
6	30	17	23	M6	10	30	
8	50	22	30	M8	14	36	
10	90	25	34	M10	16	42	

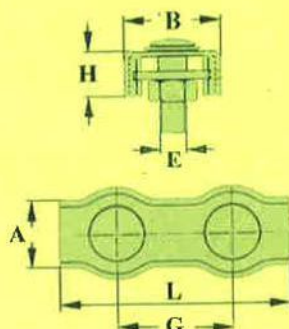

ARTICLE P2B

SERRE-CABLE PLAT 2 BOULONS SERTIS

D	PDS/G	A	B	E	H	L	G	BOITAGE
2	11	8	12	M4	5	37	18	100
3	15	9	14	M4	6.5	40	20	100
4	25	12	17	M5	7	43	21	100
5	35	14	20	M5	8.5	51	27	
6	50	17	23	M6	10	63	33	
8	100	22	30	M8	14	76	42	
10	180	25	34	M10	16	88	46	

ARTICLE P2BDEM SERRE CABLE PLAT 2 BOULONS DEMONTABLE
DU D. 2 AU D. 14 NOUS CONSULTER